



Two Bedroom Penthouse Apartment in Lapta

Lapta, Kyrenia West, North Cyprus

- Property Ref: 557
- Sea and mountains view.
- Private roof terrace.
- 500 m to the sea.
- Heated floor in bathroom and kitchen.
- The project will be made of high-quality building materials using heat and moisture insulation technologies.

Starting from
£201,500



142 m²



2 Bedrooms



2 Bathrooms



16 Months
Instalments



September 2025
Completion

Email: sales@dmgpropertygroup.com
Website: www.dmgpropertygroup.com

DMG PROPERTY
GROUP

Two Bedroom Penthouse Apartment in Lapta

Exterior Images

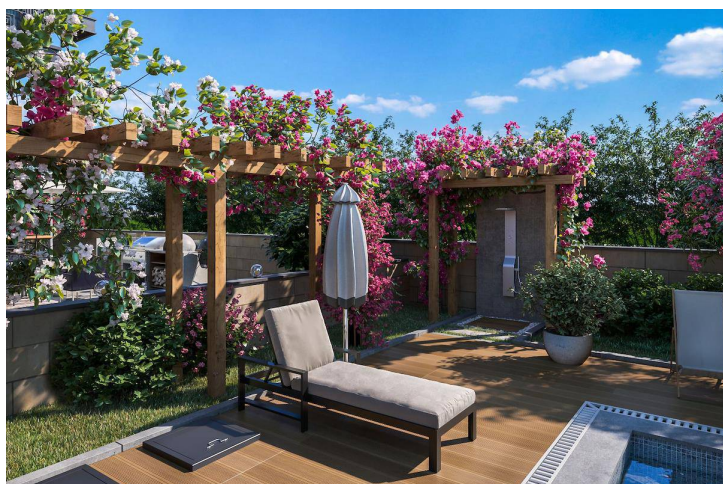
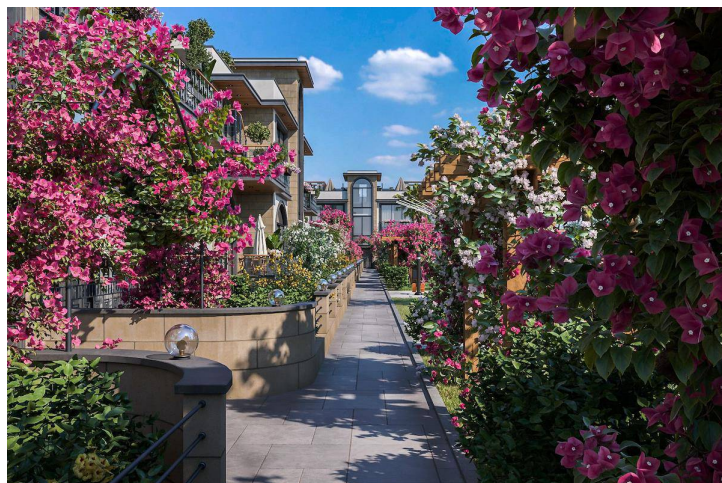
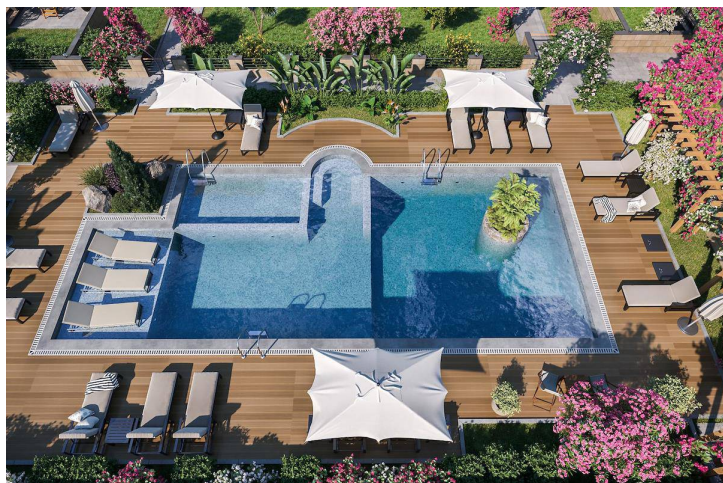

Two Bedroom Penthouse Apartment in Lapta

Floor Plan



1. KAT PLANI
A TIPI

Facilities



Children's Play
Ground



Fitness



Gardens (Landspaced)



Gated Community



Parking



Pool (Outdoor)



Yoga

Site Plan

Lapta, Kyrenia West, North Cyprus



Project Location

This project is located in a beautiful area of Lapta.

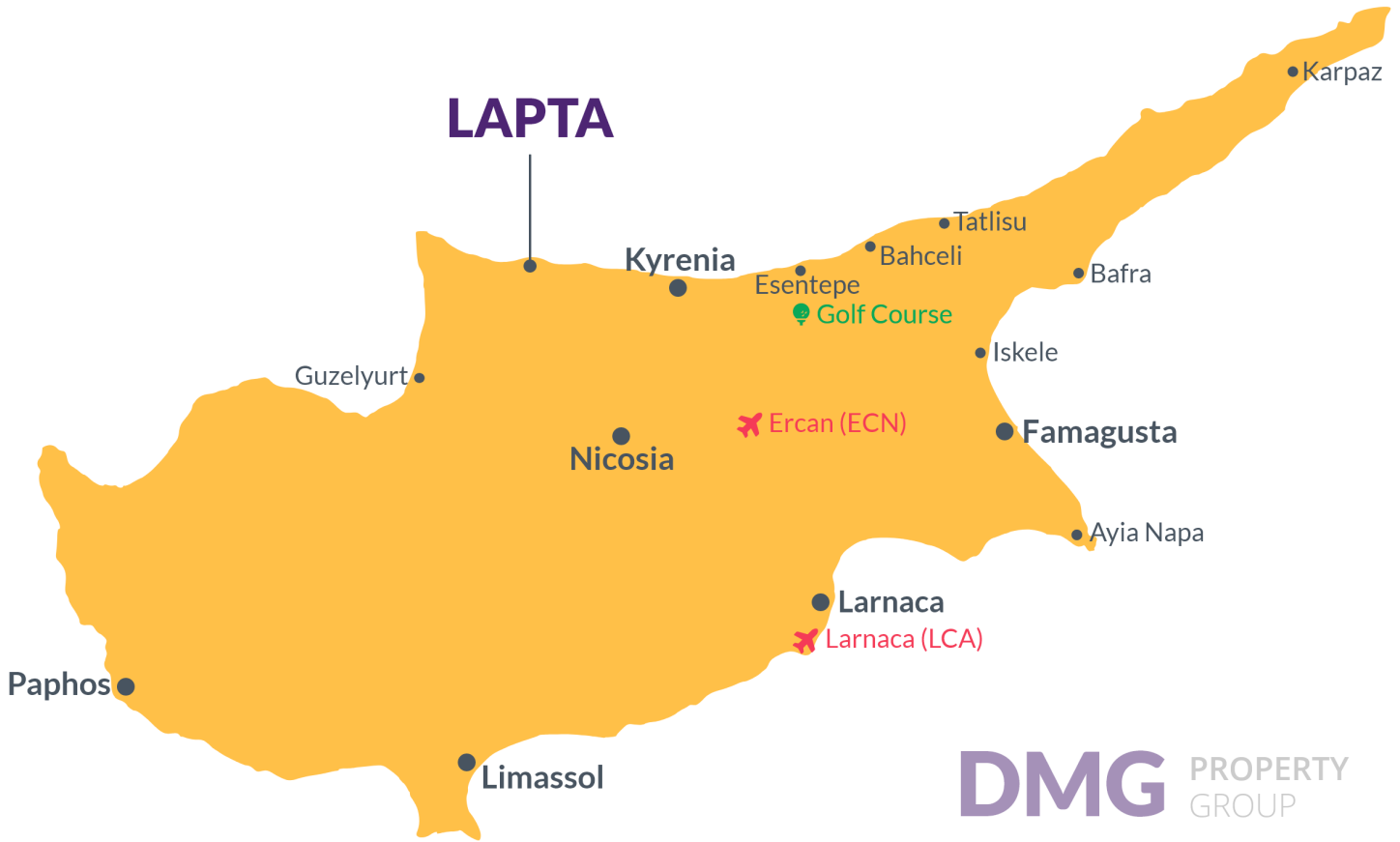

Sandy Beach	3 mins	Restaurants and Cafes	3 mins	St...
5 Star Hotels and Casinos	3 mins	Sandy Beach	3 mins	R...
Lapta Coastal Walkway	3 mins	5 Star Hotels and Casinos	3 mins	N...
Pharmacy	3 mins	Lapta Coastal Walkway	3 mins	N...
Supermarket	3 mins	Pharmacy	3 mins	K...

About the Project

Experience unparalleled luxury living amidst Lapta's lush landscapes in Northern Cyprus. These exquisite residences offer modern sophistication and breathtaking vistas, blending urban convenience with serene tranquility.

Perched just 500 meters from the sea, each apartment boasts panoramic views of mountains and greenery. Lapta, known for its pristine beauty and vibrant city life, captivates with its charm.

Indulge in comfort with amenities like heated flooring, private gardens, and sports areas. Inside, enjoy fitted kitchens, marble finishes, and laminate flooring.

Relax in the swimming pool, yoga space, or playground, all while enjoying the safety of a video surveillance system.

Escape to Lapta, where luxury meets nature in perfect harmony.

Two Bedroom Penthouse Apartment in Lapta

Construction Status

May 2024



Lowest Price Unit For This Property Type

Property Info

Type

2 Bedroom Penthouse

No

3

Block

B

Floor

1

Interior

77.80 m²

Balcony Terrace

7.20 m²

Rooftop

57.30 m²

Total Living Space

142.30 m²

Plot

102.00 m²

Lowest Price Unit For This Property Type

Payment Plan

Current Date	Start Date	Delivery Date	Price	Initial Payment Amount
May 2024	September 2023	September 2025	£201,500	£70,525 35%

65% of the installment payment plan

1. Installment June 2024	£8,186
2. Installment July 2024	£8,186
3. Installment August 2024	£8,186
4. Installment September 2024	£8,186
5. Installment October 2024	£8,186
6. Installment November 2024	£8,186
7. Installment December 2024	£8,186
8. Installment January 2025	£8,186
9. Installment February 2025	£8,186
10. Installment March 2025	£8,186
11. Installment April 2025	£8,186
12. Installment May 2025	£8,186
13. Installment June 2025	£8,186
14. Installment July 2025	£8,186
15. Installment August 2025	£8,186
16. Installment September 2025	£8,185